

Dash #	Next Assembly
-	-

REVISIONS			
REV	DESCRIPTION	DATE	APPROVED
A	Added 2X #8-32 holes and bend leads.	5/14/12	MC

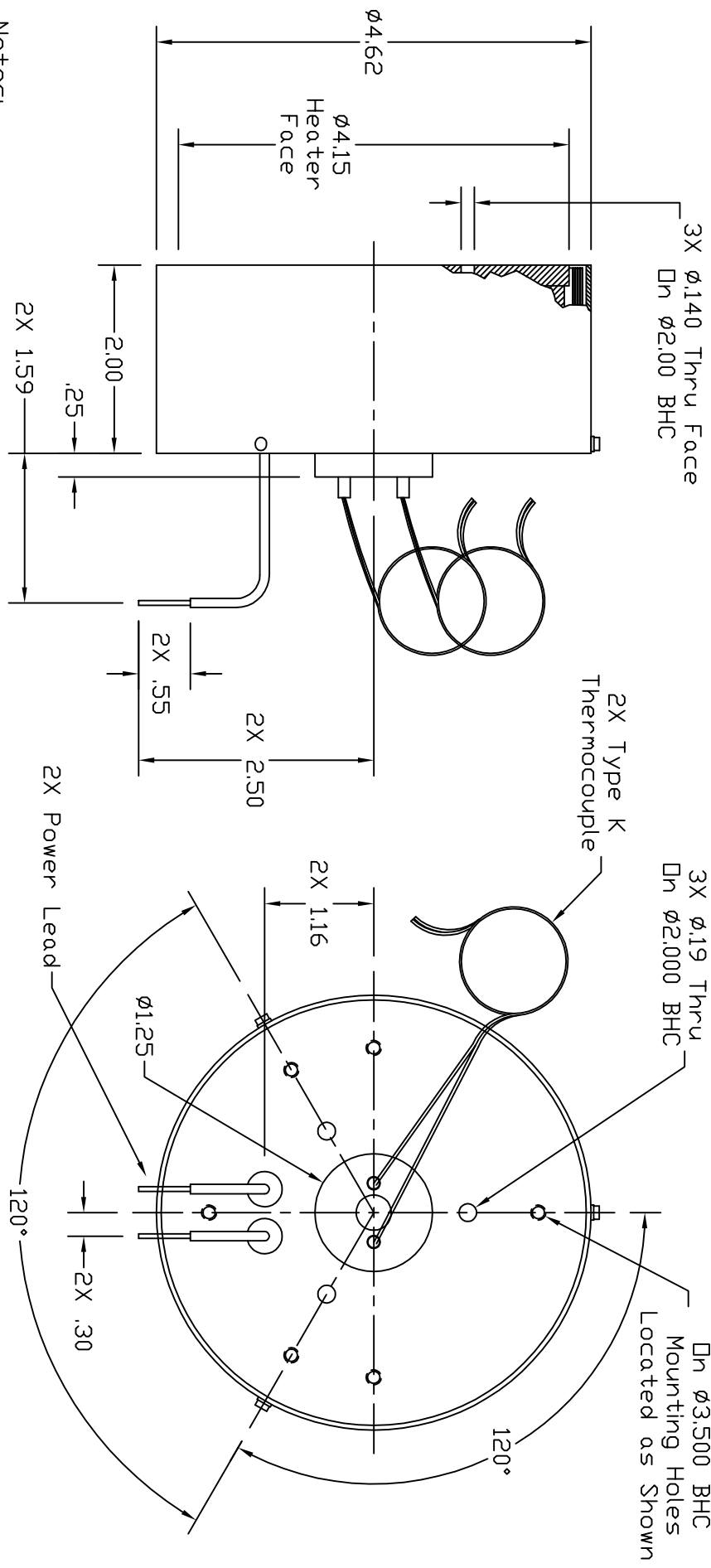

- Notes:
- Estimated operation:
 23.2V, 21.4A @ 800°C
 33.5V, 30.9A @ 1000°C
 40.2V, 38.5A @ 1200°C
 2. Heater face to be flat within .0005.

This document is the property of HeatWave Labs. Its contents may not be reproduced or distributed without express written permission of HeatWave Labs.

UNLESS OTHERWISE SPECIFIED ALL DIMENSIONS ARE IN INCHES. TOLERANCES ARE: XXX = ±.005 XX = ±.020 XXXX = ±.005 FINISH 63 MICRONDICES ANGLES 0 DEGREE ±30 MINUTES EDGES AND CORNERS .005 R MAX
MATERIAL
-

1	104539	$\phi 4.0$ UHV Heater Assembly	-
Qty.	Part #	Description	Item #
<p>HeatWave Labs, Inc. 195 Aviation Way, Suite 100 (831) 722-9081 Watsonville, Ca. 95076 Fax: (831) 722-5491 Website: www.ca.thode.com</p>			
BY	DATE	<p>$\phi 4.0$, 1200°C UHV Heater Assembly</p>	
ENGR	M.Curtis	1-30-08	
SIZE	Cage Code	DWG. NO.	REV
A	1YAN4	104524	A
THIRD ANGLE PROJECTION		SCALE: 06X	SHEET: 1/1

DO NOT SCALE DRAWING